

Светильники для чтения, встраиваемые в сиденья

PVPro-L 12/24

Архангельск (8182)63-90-72
Астана (7172)727-132
Астрахань (8512)99-46-04
Барнаул (3852)73-04-60
Белгород (4722)40-23-64
Брянск (4832)59-03-52
Владивосток (423)249-28-31
Волгоград (844)278-03-48
Вологда (8172)26-41-59
Воронеж (473)204-51-73
Екатеринбург (343)384-55-89
Иваново (4932)77-34-06
Ижевск (3412)26-03-58
Казань (843)206-01-48

Калининград (4012)72-03-81
Калуга (4842)92-23-67
Кемерово (3842)65-04-62
Киров (8332)68-02-04
Краснодар (861)203-40-90
Красноярск (391)204-63-61
Курск (4712)77-13-04
Липецк (4742)52-20-81
Магнитогорск (3519)55-03-13
Москва (495)268-04-70
Мурманск (8152)59-64-93
Набережные Челны (8552)20-53-41
Нижний Новгород (831)429-08-12
Новокузнецк (3843)20-46-81

Новосибирск (383)227-86-73
Омск (3812)21-46-40
Орел (4862)44-53-42
Оренбург (3532)37-68-04
Пенза (8412)22-31-16
Пермь (342)205-81-47
Ростов-на-Дону (863)308-18-15
Рязань (4912)46-61-64
Самара (846)206-03-16
Санкт-Петербург (812)309-46-40
Саратов (845)249-38-78
Севастополь (8692)22-31-93
Симферополь (3652)67-13-56
Смоленск (4812)29-41-54

Сочи (862)225-72-31
Ставрополь (8652)20-65-13
Сургут (3462)77-98-35
Тверь (4822)63-31-35
Томск (3822)98-41-53
Тула (4872)74-02-29
Тюмень (3452)66-21-18
Ульяновск (8422)24-23-59
Уфа (347)229-48-12
Хабаровск (4212)92-98-04
Челябинск (351)202-03-61
Череповец (8202)49-02-64
Ярославль (4852)69-52-93



POWERVERTER Pro

PVPro-L SEAT MOUNTED READING LIGHT

PVPro-L - THE DISCREET SOLUTION FOR PERSONAL SEAT MOUNTED READING LIGHTS

Achieving the correct ambient lighting in buses and coaches while driving at night can be a challenge. Some passengers may wish to snooze, others might like to read a book or magazine, check and update mobile phones or other media devices.

This causes the dilemma. Lights on or off? At night, typically lights are dimmed and passengers can choose a private reading light, usually situated in the ceiling of the vehicle which then shines on the appropriate seat, illuminating their surroundings. However, to reach from the ceiling, such lights need to be quite bright. This can cause annoyance to nearby passengers, as well as a significant rear view distraction to the driver as lights flash on and off while the vehicle is in motion. The Alfatronix PVPro-L reading light offers the ideal solution. It can be installed in the back of the seat in front. The light ray can be directed to the left or right as well as forward or backwards for discreet, yet maximum comfort for both the user and their neighbours.



PowerVerter USB PVPro-D and PVPro-L

As it is situated behind the seat, there is no stream of light from the ceiling, so neither the driver nor other passengers are distracted. The PVPro-L reading light is designed to match with our already popular PVPro range of USB chargers. With passenger accessible charging and directable personal lighting, these two products offer a simple and inexpensive offering that significantly enhances customer experience.

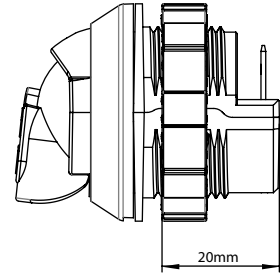

Slim design can be installed with as little as 20mm rear space.



Directable personal lighting, easy to switch on and off.



| Part Number | Description | Dimensions (mm) | Weight |
|-------------|----------------------------------|--------------------|--------|
| PVPro-L | 12/24 seat mounted reading light | Ø37 x 45; Hole Ø30 | 19g |

For 12/24 Vdc USB Chargers, please see our PowerVerter Pro Range.

TECHNICAL DATA

| | |
|--------------------------------------|---|
| Input voltage range | 9-32Vdc |
| Output light | 500 lux @ 0.25m, 225 lux @ 0.5m |
| Application | Directable reading light for installation in seat back |
| Transient voltage protection | Meets ISO7637-2 International standard for 12/24V vehicles |
| Off load current (quiescent current) | < 2mA @ 12V, 7mA @ 24V |
| Power conversion efficiency | Light on 98mA @ 12V, 48mA @ 24V |
| Operating temperature | -25°C to +55°C to meet this specification table |
| Storage temperature | -25°C to +100°C |
| Operating humidity | 95% max., non-condensing |
| Casework | Polycarbonate body |
| Connections | Input: 6.3mm push-in flat blade connectors On/off switch incorporated |
| Output indicator | Blue LED output indication when reading light off |
| Mounting method | 30mm diameter hole with or without bezel. |
| Safe area protection: | Over heat Limited by temperature sensing circuit Overvoltage and Undervoltage Limited by sensing circuit Reverse Polarity Limited by sensing circuit Transients Protected by filters and rugged component selection Catastrophic protection Internal fuse |
| Approvals | 2014/30/EU The general EMC directive Regulation 10 The automotive directive 93/68/EEC The CE marking directive AES5, ECE R118.02 and UL 94: V-0 |
| Designed to | EN50498, EN61373, EN45545-2 and ISO 7637-2 To fully meet railway approval to EN50155 & EN50121-3-2 the PVPro-L is to be used in conjunction with a PV6i-R or PV12i-R Please see PowerVerter PVPro Railway |
| Markings | CE and E (automotive) marked |
| IP Rating | IP30 |

По вопросам продажи и поддержки обращайтесь:

Архангельск (8182)63-90-72
Астана (7172)727-132
Астрахань (8512)99-46-04
Барнаул (3852)73-04-60
Белгород (4722)40-23-64
Брянск (4832)59-03-52
Владивосток (423)249-28-31
Волгоград (844)278-03-48
Вологда (8172)26-41-59
Воронеж (473)204-51-73
Екатеринбург (343)384-55-89
Иваново (4932)77-34-06
Ижевск (3412)26-03-58
Казань (843)206-01-48

Калининград (4012)72-03-81
Калуга (4842)92-23-67
Кемерово (3842)65-04-62
Киров (8332)68-02-04
Краснодар (861)203-40-90
Красноярск (391)204-63-61
Курск (4712)77-13-04
Липецк (4742)52-20-81
Магнитогорск (3519)55-03-13
Москва (495)268-04-70
Мурманск (8152)59-64-93
Набережные Челны (8552)20-53-41
Нижний Новгород (831)429-08-12
Новокузнецк (3843)20-46-81

Новосибирск (383)227-86-73
Омск (3812)21-46-40
Орел (4862)44-53-42
Оренбург (3532)37-68-04
Пенза (8412)22-31-16
Пермь (342)205-81-47
Ростов-на-Дону (863)308-18-15
Рязань (4912)46-61-64
Самара (846)206-03-16
Санкт-Петербург (812)309-46-40
Саратов (845)249-38-78
Севастополь (8692)22-31-93
Симферополь (3652)67-13-56
Смоленск (4812)29-41-54

Сочи (862)225-72-31
Ставрополь (8652)20-65-13
Сургут (3462)77-98-35
Тверь (4822)63-31-35
Томск (3822)98-41-53
Тула (4872)74-02-29
Тюмень (3452)66-21-18
Ульяновск (8422)24-23-59
Уфа (347)229-48-12
Хабаровск (4212)92-98-04
Челябинск (351)202-03-61
Череповец (8202)49-02-64
Ярославль (4852)69-52-93

Единый адрес для всех регионов: axt@nt-rt.ru || www.alfatronix.nt-rt.ru

Power conversion and battery management products for communications, marine and automotive applications

Produits de conversion d'énergie et de gestion de batterie pour les applications des secteurs communications, marine et automotive

Spannungswandler und Batterie-Management Produkte für Kommunikations-, Marine- und Fahrzeuganwendungen

Productos de conversión de energía y gestión de baterías para aplicaciones en los campos de la comunicación, marítimo y de la automoción

